

PROCORE

The capacity to do more



PROCORE

The capacity to do more

Projects Assisted by PROCORE

Gorgon	Australia
Hebron	Newfoundland
Neftegaz Arkutun-Dagi	Sakhalin Islands, Russia
Wheatstone	Australia
Neftegaz Odoptu	Sakhalin Islands, Russia
Yanbu Refinery	Saudi Arabia
Jack St. Malo	Gulf Region
Big Foot	Gulf Region
Macedon	Australia
Mad Dog	Gulf Region
Lucius	Gulf Region





PROCORE

The capacity to do more

Piping Specialties - Kitting

Job Traveler

Job: 266834-9-1

Asm: 0



Part: 275C343KIT9



Description: RT - PLAN 23 PIPE KIT

OPERATIONS:

Seq No.	Oper.	Description	Oper. Qty	Res.	Setup Est. Hours
8	ETCH	Electro Etching	4.00	1.00	0.05



***** Etch *****

- log into all related jobs to be etched simultaneously
- NO MATERIAL is to be etched until it has been processed through OPERATION #3 - Inspection
- generate labels to perform etching and log time against Operation SET UP Activity
- log into PRODUCTION ACTIVITY for the actual etching of material

Scheduling Resources

Dtl. Seq.	Res. Grp.	Resource
10	WRHSGEN	58





PROCORE

The capacity to do more

Piping Specialties - Kitting

AML

CMTR

Country of Origin

RT

PT

3.2

CRN

Traceable

Documentation

Serialized

Exotic Alloy





PROCORE

The capacity to do more

Subassembly & Actuation



FULL PENETRATION BUTT WELD
TYPICAL ON ALL JOINTS

AUTOMATIC BALL ISOLATION VALVE ASSY.
(LOCATE SOLENOID ON THIS SIDE OF ASSY.)

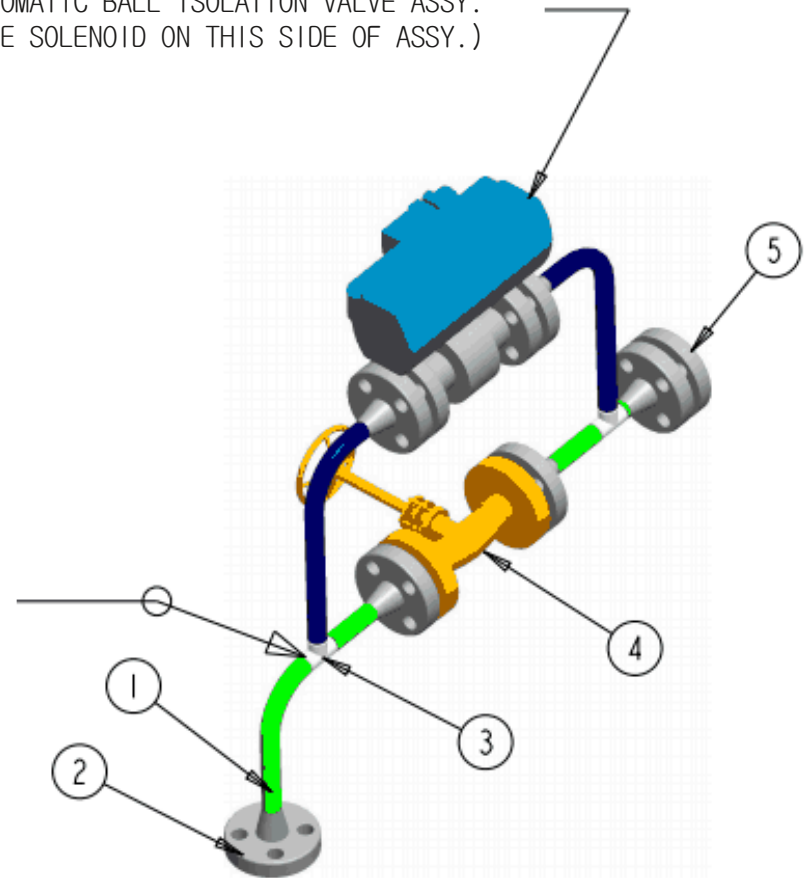



PROCORE

The capacity to do more

Electrical & Instrumentation, Kit & Subassembly

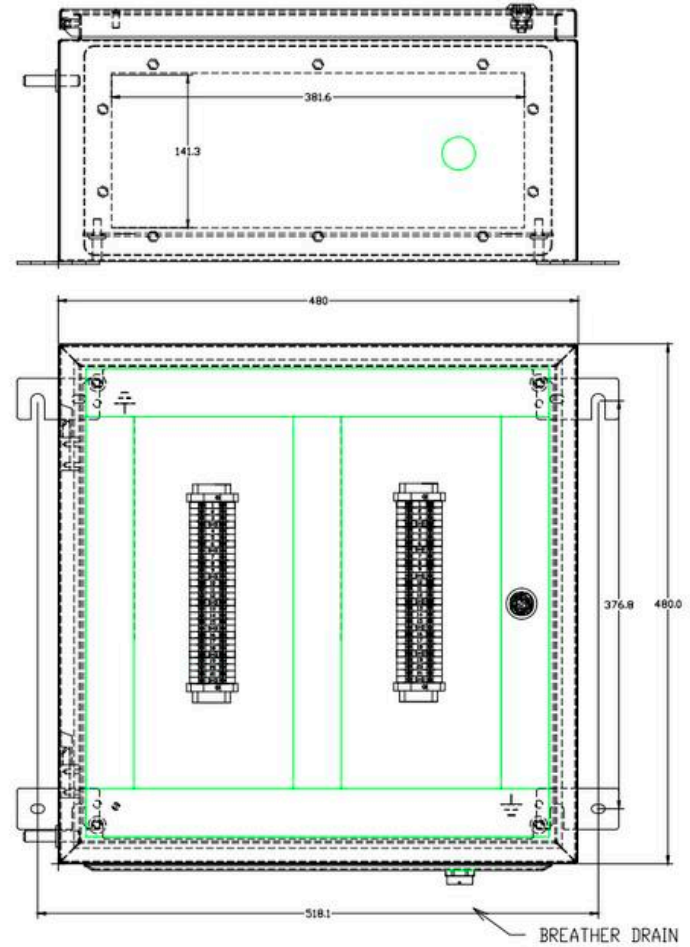
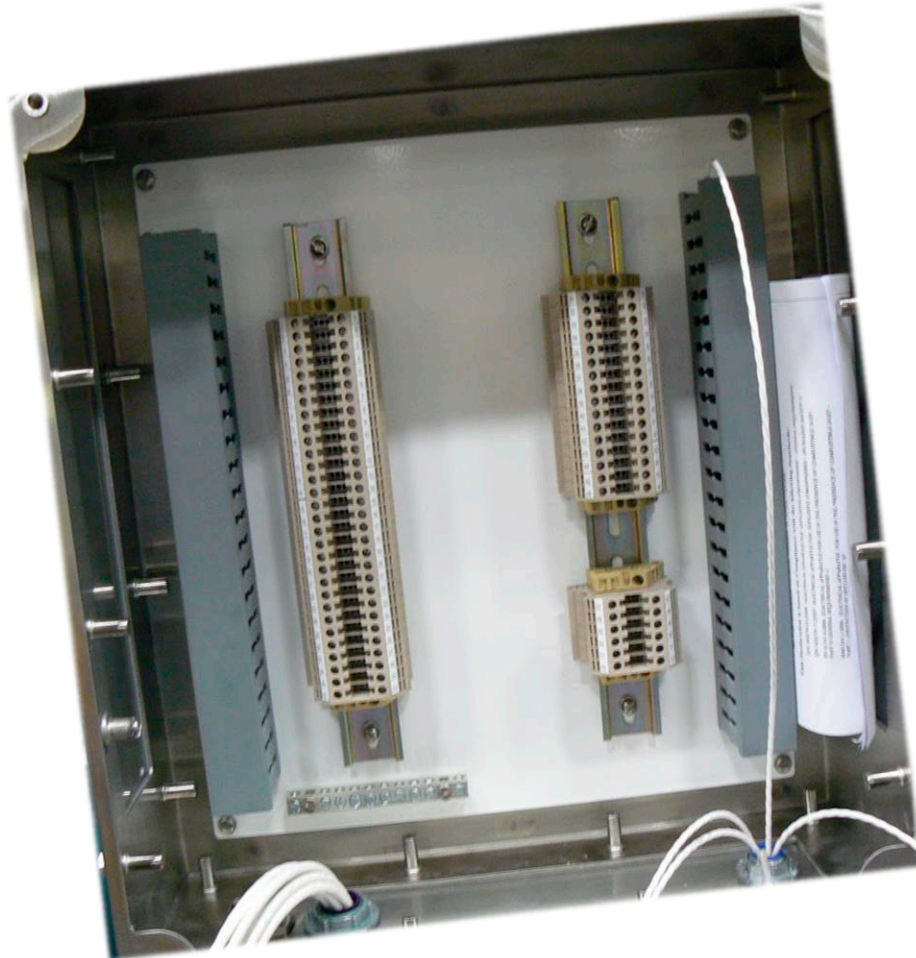

INDUSTRY STANDARD
ATEX DIRECTIVE 94/9/EC
ATEX
SIRA 09ATEX3324U
Ex e IIC Gb
Ex tb IIIC Do IP66

IECEX
IECEX SIR809.0099U
Ex e IIC Gb
Ex tb IIIC Do IP66



PROCORE

The capacity to do more

**Electrical & Instrumentation,
Kit & Subassembly**





PROCORE

The capacity to do more

Electrical & Instrumentation, Kit & Subassembly

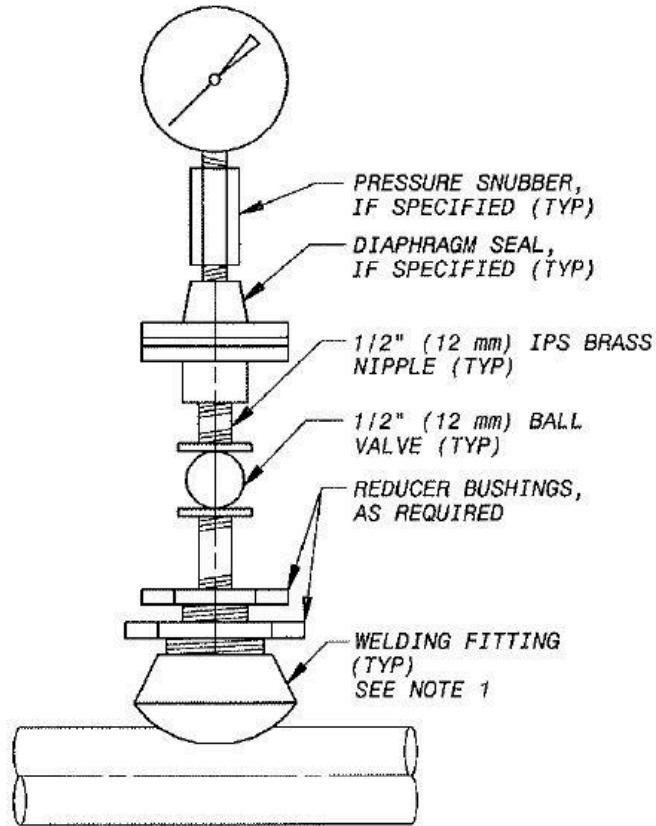

HORIZONTAL RUN

NO SCALE

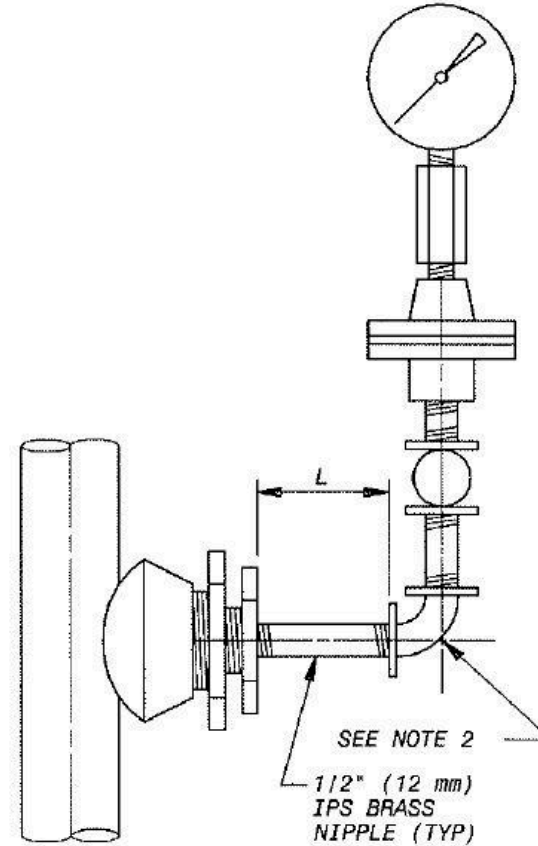

VERTICAL RUN

NO SCALE



PROCORE

The capacity to do more

Custom Manufactured & Machines Components



ITEM	DESCRIPTION
1	INLET/OUTLET FLANGE
2	BODY ELBOW
3	WASHER RING
4	BODY RING
5	BODY TIE
6	SCREEN
7	SCREEN SUPPORT
8	BODY FLANGE
9	COVER FLANGE
10	COVER NUTS
11	COVER STUDS
12	COVER GASKET
13	SP PROCESS FLANGE
14	SP PROCESS PIPE
15	LIFTING LUG
16	LOWER EXTENSION PIPE
17	UPPER EXTENSION PIPE

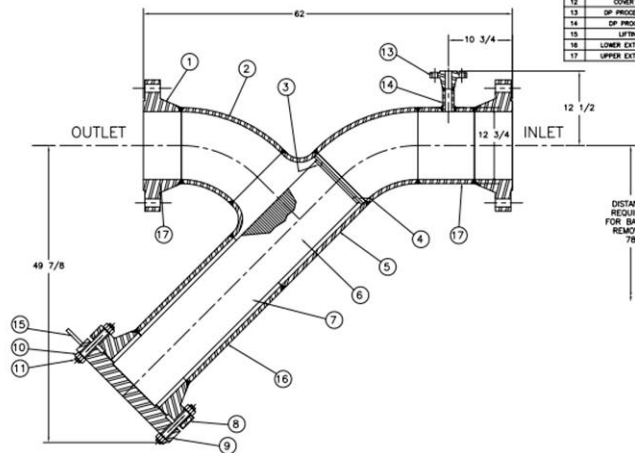

DISTANCE
REQUIRED
FOR BASKET
REMOVAL
78





PROCORE

The capacity to do more

**Engineered Expansion Joints
& Metal Hose**





PROCORE

The capacity to do more

Engineered Expansion Joints & Metal Hose

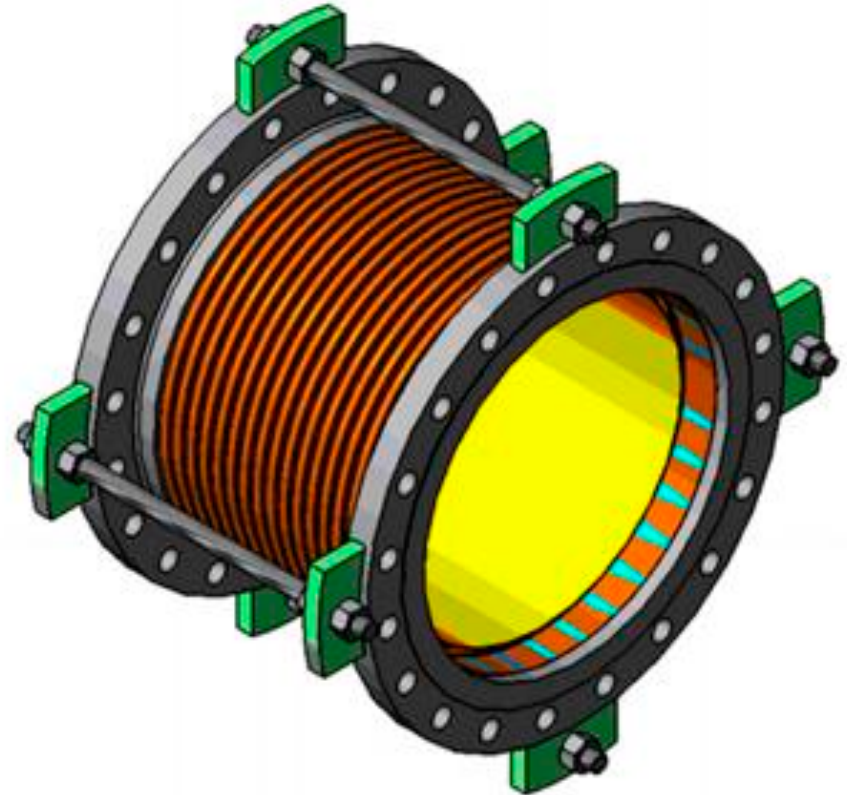
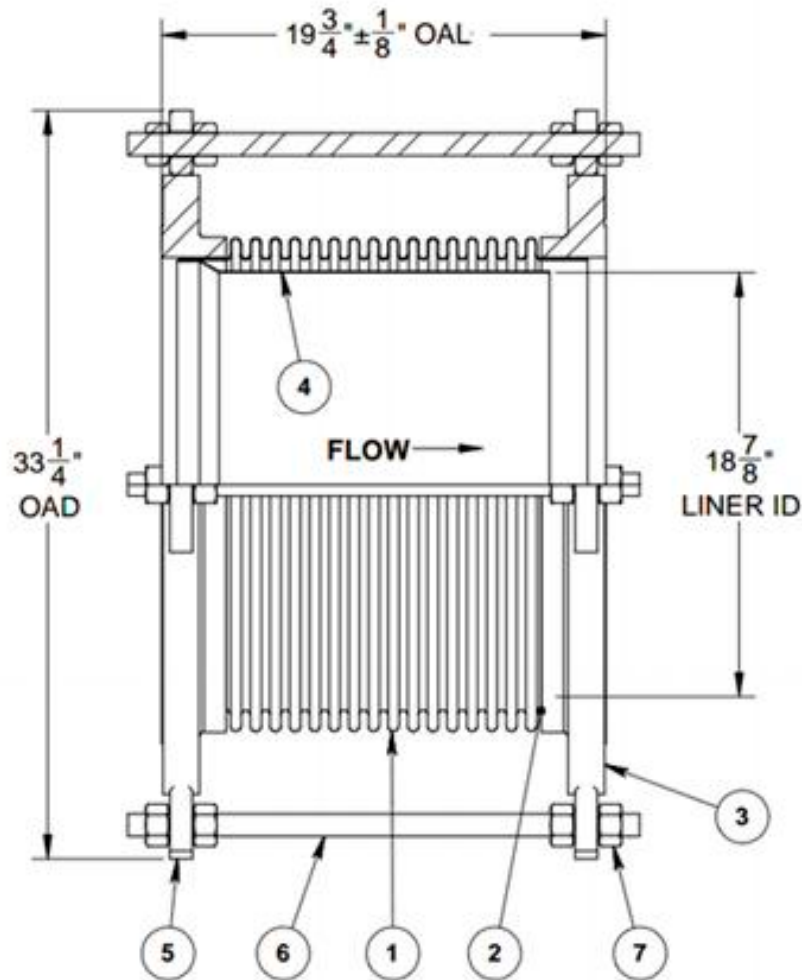



PROCORE

The capacity to do more

- Reduced vibrational stresses.
- Cost savings with exotic material designs are huge.

Custom Engineered Valve Solutions

CONVENTIONAL

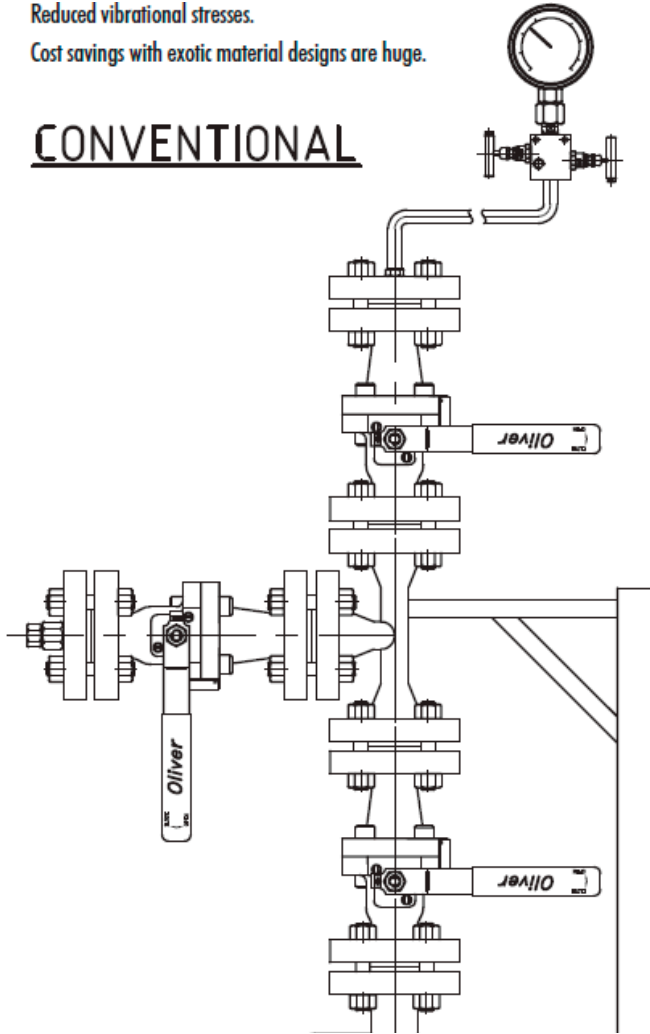

OLIVER VALVES SOLUTIONS

DOUBLE
BLOCK AND
BLEED FLANGE
TO FLANGE

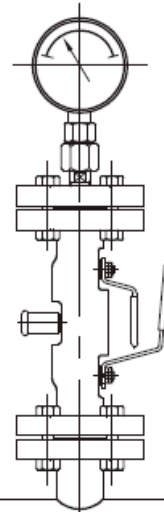

DOUBLE
BLOCK AND
BLEED FLANGE
TO SCREW

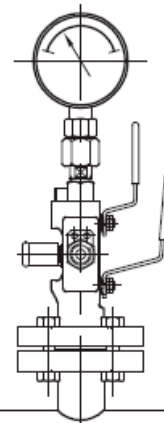

DOUBLE BLOCK
AND BLEED
SLIMLINE
MONO FLANGE

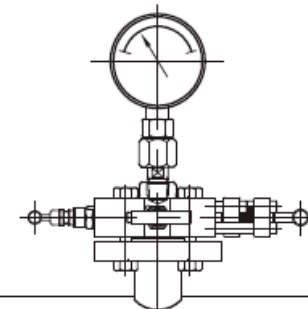

DOUBLE
BLOCK AND
BLEED
MONO FLANGE

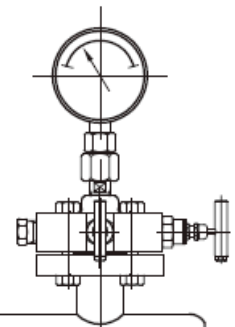

oliver valves



PROCORE

The capacity to do more

Custom Engineered Valve Solutions





PROCORE

The capacity to do more

Rapid Response for Field Services



Punch List – 4/03/13, Norm – Complete for next Wed. install.

- Mounting Brackets For Valves – reduce the sharp edges by grinding the corners to a more rounded finish.
- Drain valves – add a “cut” nipple.
- Relief valve – Orient the relief valve 45° (towards electric valve) and include drain tube, elbow to ground.
- Kamloks – Change to Stainless
- Control Panel – clips on one unit need to be fastened properly (lose time).
 - Need to check wiring and successfully run batch operation.
 - The electrically actuated valve is not tied in properly at this time.
- Bolts – Between the electrically actuated valve and the piping need to be long enough to engage the thread lock on the nuts. This applies to one connection on each skids (4 bolts each).
- Cleaning – Do a once over on rough edges, teeth marks from wrenches on piping.
- Leak at Valve – Check leak at TEE and valve on one unit.

NOTE: Must be offsite by COB Friday!!

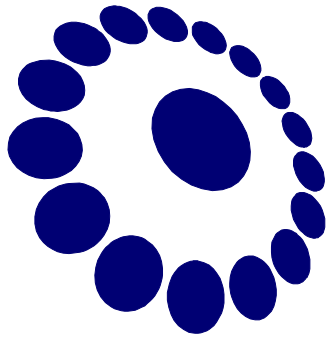

PROCORE

The capacity to do more

www.peerlessprocore.com